



# Zilla® Helical Pier

## Installation Instructions

Patent Pending

Each Zilla® Helical Pier can be installed in less than a minute using locally sourced compact excavator, skid steer or other equipment with a rotational downward force — saving you time and money.

### Parts & Tools needed (in addition to the Zilla® Helical Pier)

- Compact excavator, skid steer, or other equipment with rotational and downward force
- Output shaft compatible with 2-9/16" round driver (Bobcat Model 15 / 15C)
- Zilla® Helical Pier Driver

 [VIEW INSTALLATION VIDEO](#)

### Installation Steps

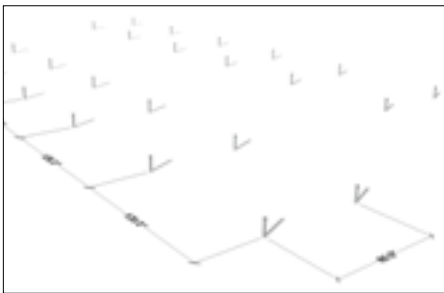

**1 Prepare**  
Locate Zilla® Helical Pier locations per plan design.

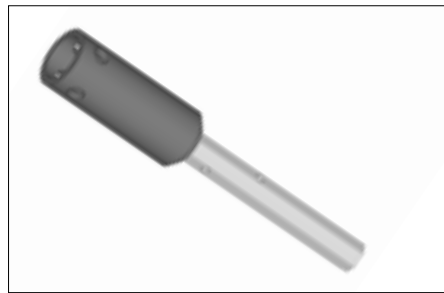

**2 Install**  
Install the Zilla® Helical Pier Driver onto your compact excavator, skid steer, or other equipment.

**Tip:** Compact Excavators can save substantial time by allowing the operator to drive multiple Helical Piers from a single location.

**Place the Zilla® Helical Pier** on the marked location per design and insert the Zilla® Helical Pier Driver into the Zilla® Helical Pier shaft. Ensure the Zilla® Helical Pier is plumb.

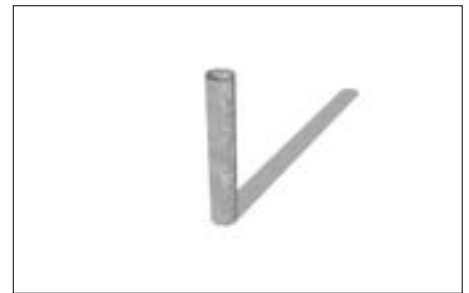

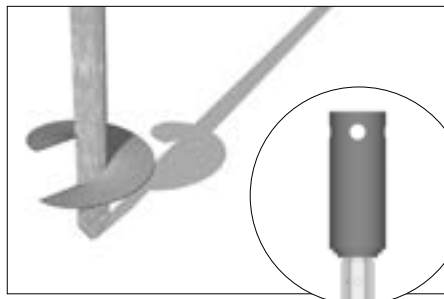

**3 Complete the installation**  
Drive the Zilla® Helical Pier by applying downward and rotational force. The Helical Pier should screw itself into the soil, not auger out a hole. Ensure the Zilla® Helical Pier stays plumb. Drive the Zilla® Helical Pier down to the depth required by plan.

**Repeat steps 2 and 3 for all Helical Piers required by plan.**



Zilla® So Simple It's Scary<sup>SM</sup>

77 Waneka Pkwy • Lafayette • CO 80026 • 720.880.6700 • fax 303.655.0379 • [zillarac.com](http://zillarac.com)

 MADE IN USA  MADE WITH RECYCLED MATERIAL © 2014 Zilla Corporation. All rights reserved.

v040414