



# Zilla® Electrical Flashing Assembly

## Installation Instructions

US Pat. 8,479,455 • ZEFLSH-A AL BLK / ZEFLSH-A AL MF<sup>1</sup>

Use the following instructions to install the Zilla® Electrical Flashing Assembly on asphalt shingled roofs and vertical walls.

### Parts included in the assembly:

- Zilla® Electrical Base Plate
- Zilla® Electrical Flashing
- Zilla® Aluminum Flashing Adapter with 2 O-Rings
- 4 - 1/4" x 1-1/2" Zilla® Lags

### Parts & Tools needed (in addition to the assembly):

- Drill/Driver
- Ø 1-1/2" hole saw or paddle bit
- 3/8" Driver

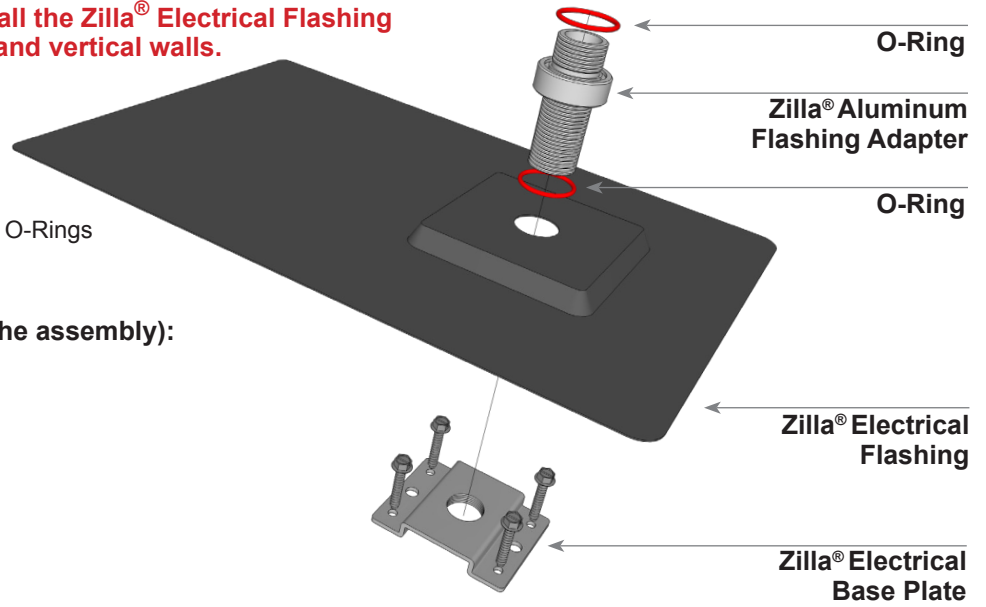

## Installation Steps

### 1 Attach Base Plate

Choose the general area on the roof where you wish to create a hole.

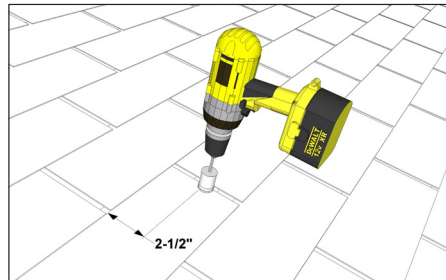

**Measure** ~2-1/2" down from the edge of the upper shingle where you wish to drill and create a center mark for your hole. Make sure there are no rafters, bracing, or other obstacles directly beneath where you plan to create your hole. Drill a through hole using a Ø1-1/2" hole saw or paddle bit.

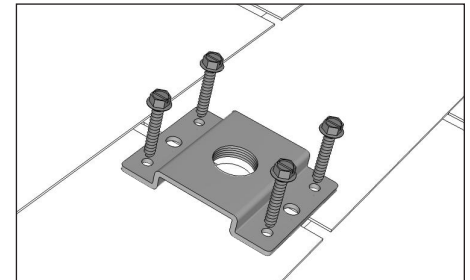

**Place the Base Plate** face down on the shingles. Center the center hole of the Base Plate over the hole in the roof. Rotate the Base Plate so it's square and level with the final flashing location.

Use a 3/8" Driver to secure the lags through the Base Plate into the roof sheathing.

**Note:** Do not pre-drill roof surface. Lag bolts will be tight into Base Plate.

<sup>1</sup> Flashing available in Mill and custom colors, call for details and availability, minimum orders may apply.

Continued on next page

Zilla® So Simple It's Scary<sup>SM</sup>

77 Waneka Pkwy • Lafayette, CO 80026 • 720.880.6700 • fax 303.664.1268 • zillarac.com

MADE IN USA MADE WITH RECYCLED MATERIAL © 2016 Zilla Corporation. All rights reserved.



# Zilla® Electrical Flashing Assembly

## Installation Instructions Continued

US Pat. 8,479,455 • ZEFLSH-A AL BLK / ZEFLSH-A AL MF<sup>1</sup>

### Installation Steps

**2 Attach the Electrical Flashing**  
Carefully install the Flashing under the shingle course above with the required coverage. Follow shingle manufacturer recommendations and AHJ requirements for exposure and proper coverage.

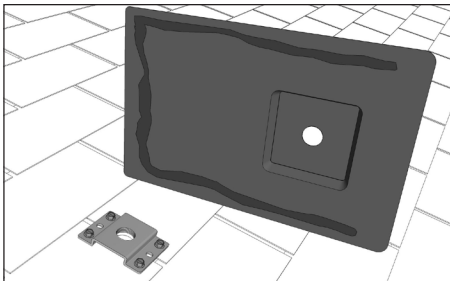

**Optional:** On the underside of the Flashing, apply a bead of caulk to the top and both sides of the Flashing prior to installation for added protection. Do not caulk the lower sloped edge of the Flashing.

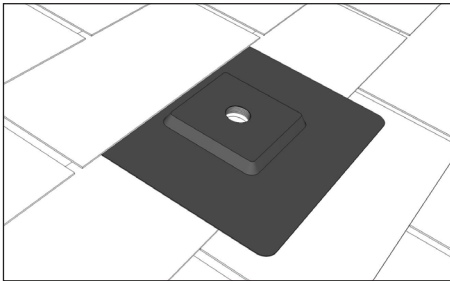

**Insert the Flashing as parallel** as possible with the roof to minimize disruption of existing shingles. Center the hole in the Flashing with the hole in the Base Plate.

**3 Mount the Aluminum Flashing Adapter**

**Thread** the longer end of the Adapter through the Flashing and into the Base Plate. Thread until the O-Ring is fully compressed and seated against the Flashing.

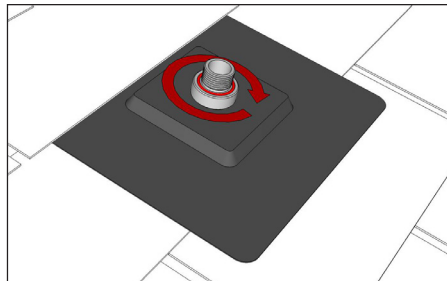

**Note:** Make sure Flashing is completely in contact with Base Plate.

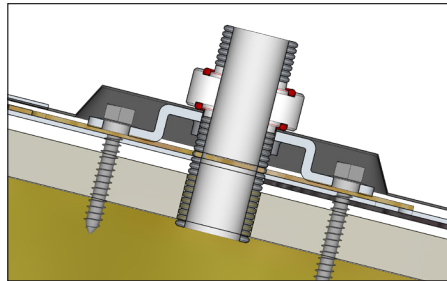

**Note:** Channel locks may be used to tighten Adapter to seat O-Ring.

**DO NOT OVERTIGHTEN!**

**4 Complete the Installation**

**Attach components** such as a Conduit Body or Junction Box as necessary.

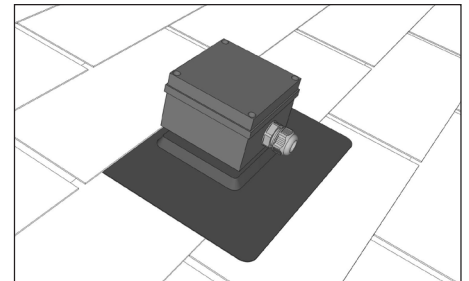

**Note:** when using a component, insert the second O-Ring between the Adapter and body of the box to create a water tight seal.

### Disclaimer

The installer is fully responsible for getting the system verified and approved for all local and state building codes and all Authorities Having Jurisdiction (AHJ). Zilla Corporation assumes no liability whether assumed or implied.

<sup>1</sup> Flashing available in Mill and custom colors, call for details and availability, minimum orders may apply.

Zilla® So Simple It's Scary<sup>SM</sup>

77 Waneka Pkwy • Lafayette, CO 80026 • 720.880.6700 • fax 303.664.1268 • [zillarac.com](http://zillarac.com)

MADE IN USA MADE WITH RECYCLED MATERIAL © 2016 Zilla Corporation. All rights reserved.